

## NBS-Rotatorcarriage

Heavy-duty galvanised rotator carriage assembly for NBS-Tiltmast

Dual securing plates for extensions pole or rotator

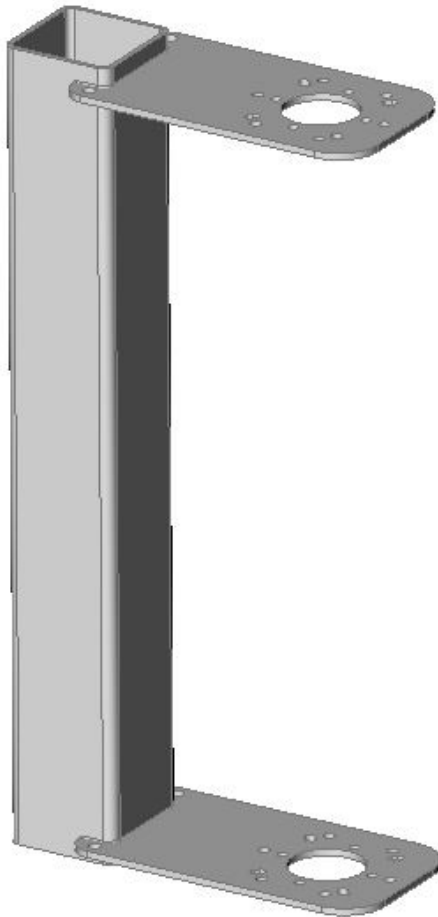

### Specifications

|                           |   |
|---------------------------|---|
| Construction              | Fully-galvanised steel SHS tube and dual securing plates with rotator mount and through holes/slots   |
| Suitable mast             | NBS-Tiltmast with NBS-Toppulley mount + NBS-RBW**** hand crank winch and 2.0-8.0m 80mm SHS extension pole   |
| Overall Dimensions        | Overall height: 700mm<br>Between plate spacing: 658mm<br>Plate Mount holes: 6 x 10mm & 4 x 9mm<br>Plate Mount slots: 4 x 9mm x 13.5mm<br>Rotator through hole: 66mm |
| Weight                    | 12.02kg   |
| Winch cable connect holes | 2 x 12mm per plate, also can be used on top plate to route cable to stop rotator/antenna interference   |
| Suitable Accessories      | NBS-RC Mount kit<br>NBS-RC Bush kit<br>NBS-RBW**** series<br>NBS-Toppulley mount  |

